

## Spis treści / Table of contents

---

Cutting and drilling.....	p.2
Adhering and connecting LED strips.....	p.3
Attaching covers and end caps.....	p.4
Sealing the extrusion.....	p.5
Connecting extrusions using ZM connectors.....	p.6

**1.** Before cutting the extrusion with the cover, secure the cutting point with self-adhesive tape.

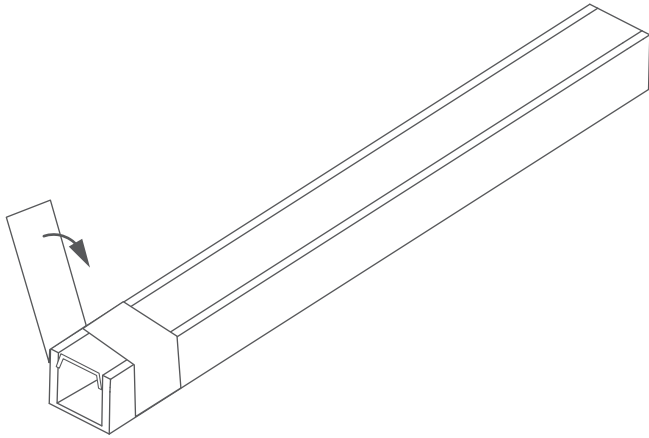

**2.** Use a mechanical saw to cut.

**NOTE!** It is recommended that the cover be cut 2 mm shorter than the extrusion to account for its thermal expansion.

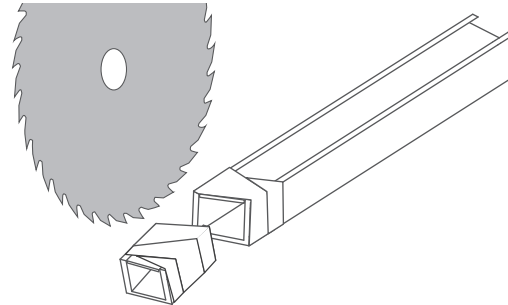

- 2mm



**NOTE!** Low precision cutting of the extrusion and cover can be done with a hand saw, however, uneven, jagged edges will remain, and the covers may break.

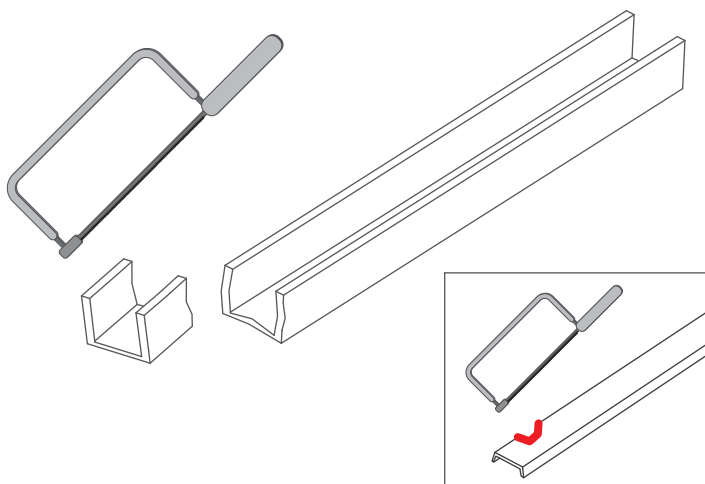

**NOTE!** For some extrusions there are dedicated end caps that require adequate shortening of the cover.

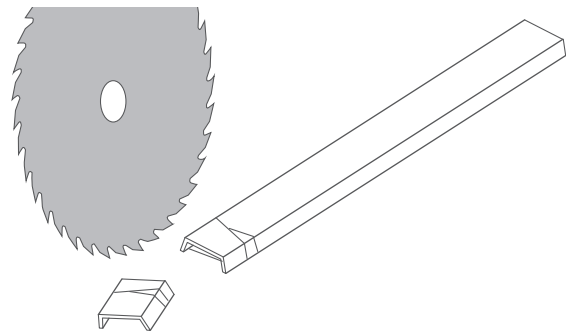

**3.** Drill a hole in the extrusion in the selected place.

**NOTE!** Make sure that there are no burrs around the hole after drilling as they can damage the LED strip or cable.

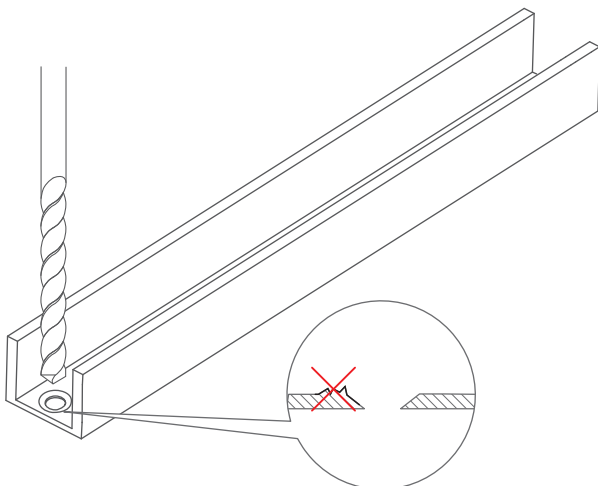

**NOTE!** Some extrusions feature one or more special grooves that make it easier to start drilling.

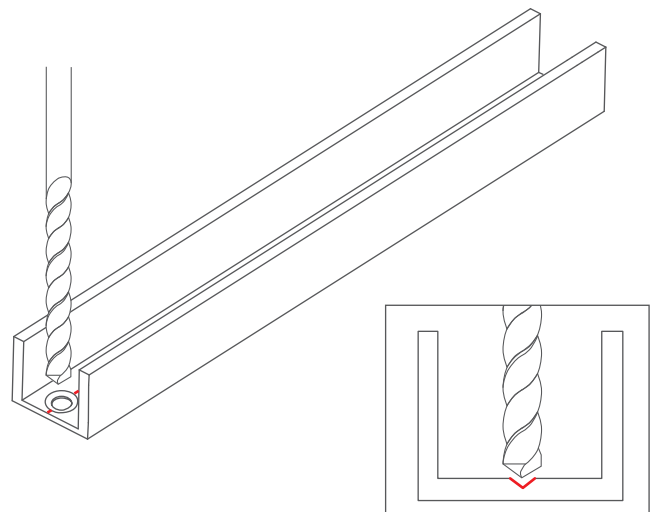

**1.** Remove the protective layer of the LED strip.

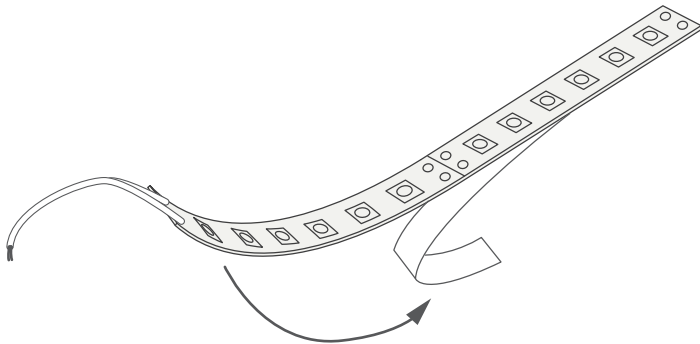

**2.** Attach the tape in the extrusion using the adhesive provided on the LED strip.

**NOTE!** The tape must not be bent or peel off the surface.

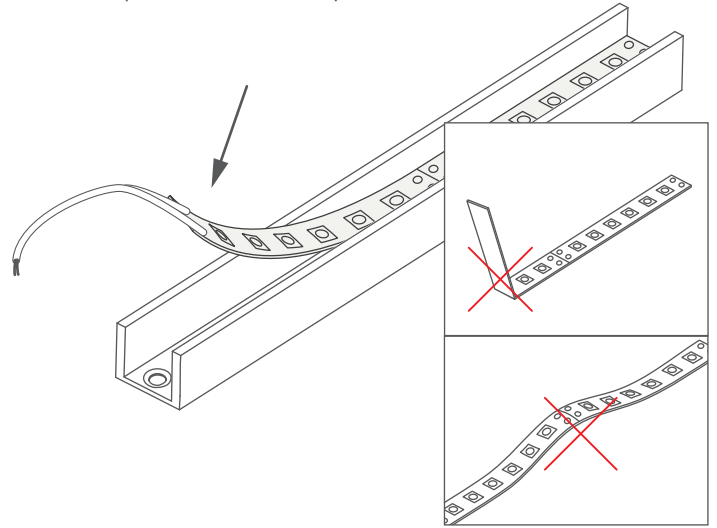

**3.** Lead the power cable through the drilled hole.

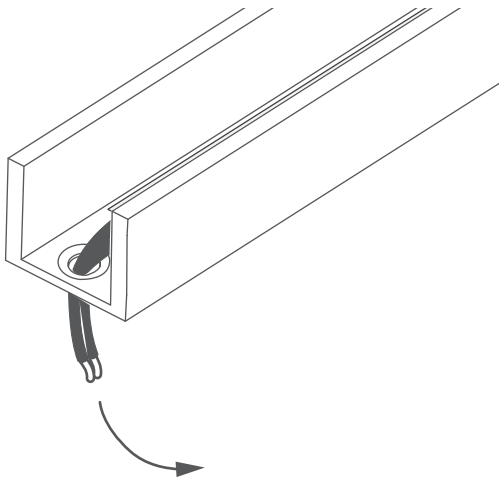

**4.** Connect the LED strips with wires by soldering.

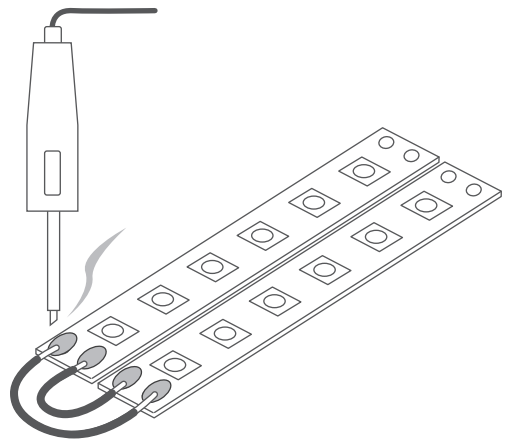

**OPTIONALLY:** The LED strips can also be connected using a system of LED strip connectors. More information at [www.klusdesign.eu](http://www.klusdesign.eu)

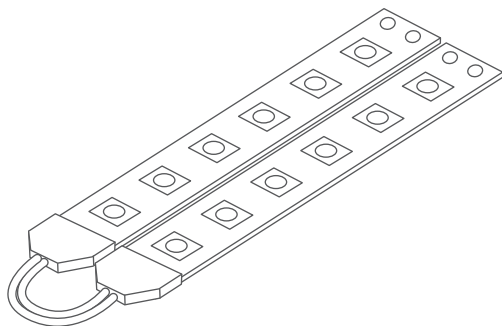

**OPTIONALLY:** The power cords can be led out from one pole of a given strip. This method is used to power suspended lighting fixtures.

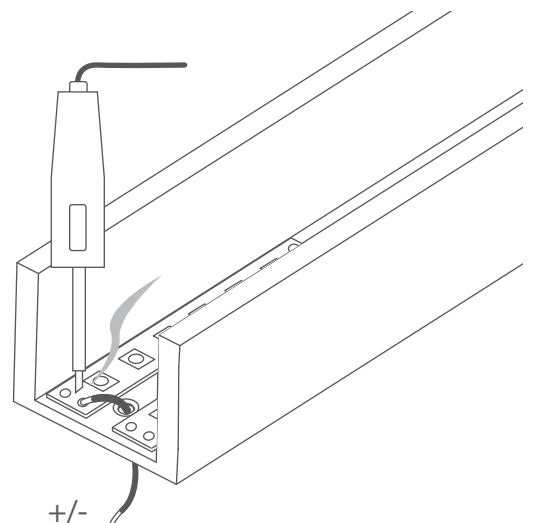

**1.** Insert the tip of the cover into the extrusion.

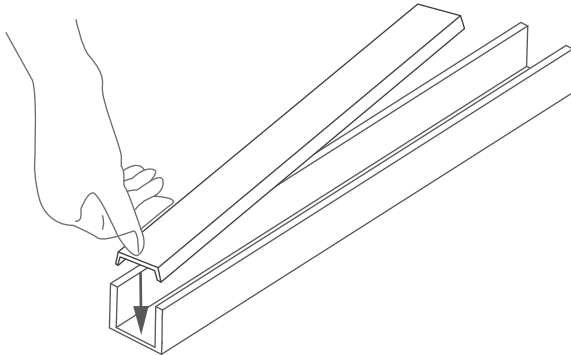

**2.** Press in the subsequent sections of the cover. Be careful not to bend or break the wings of the cover.

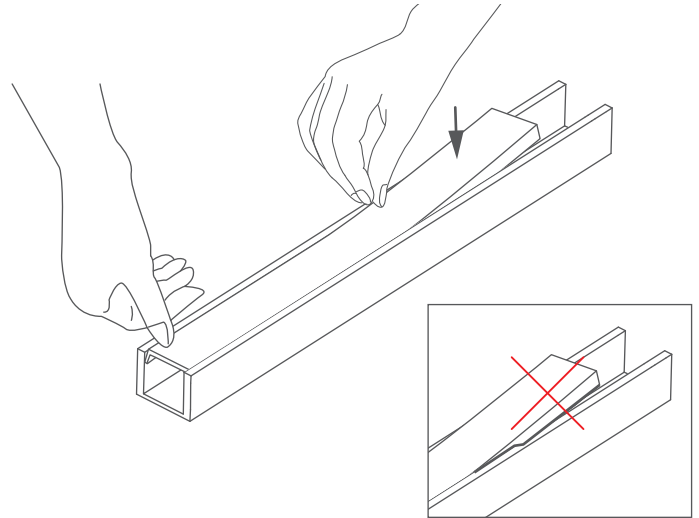

**OPTIONALLY:** Short sections, can also be inserted from the edge of the extrusion.

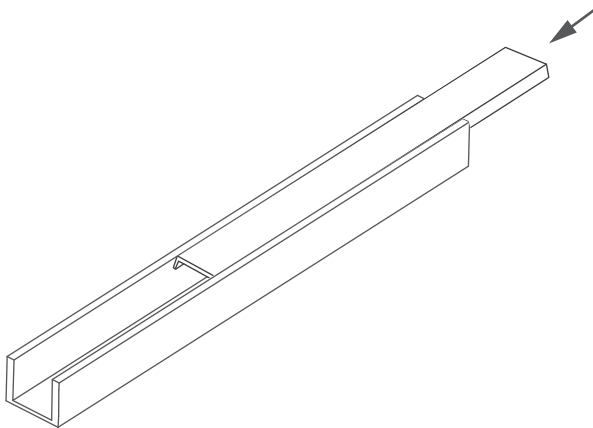

**3.** Insert an end cap into the edge of the extrusion. Individual extrusions have a shape that allows easy installation of dedicated end caps.

**NOTE!** Some end caps require an adequately shortened cover. This should be taken into account when cutting the extrusion and the cover.

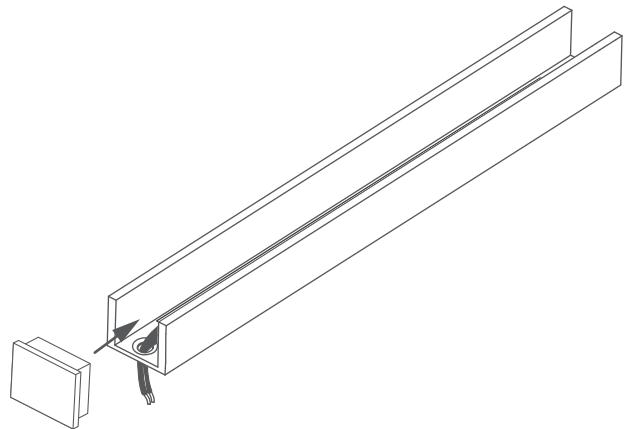

**OPTIONALLY:** The end caps can be attached to the extrusion using glue.

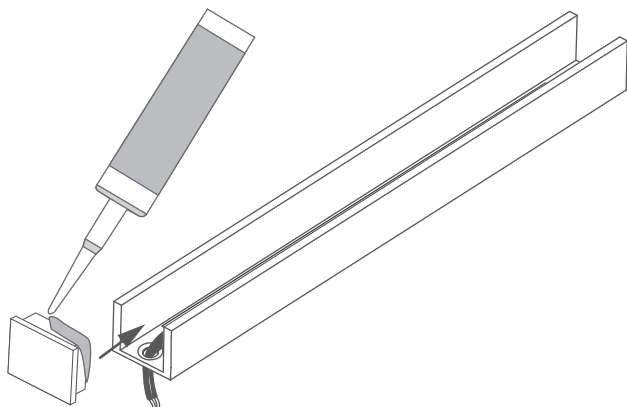

**OPTIONALLY:** Power cables can be run through the end caps in which case the extrusion does not need to be drilled through.

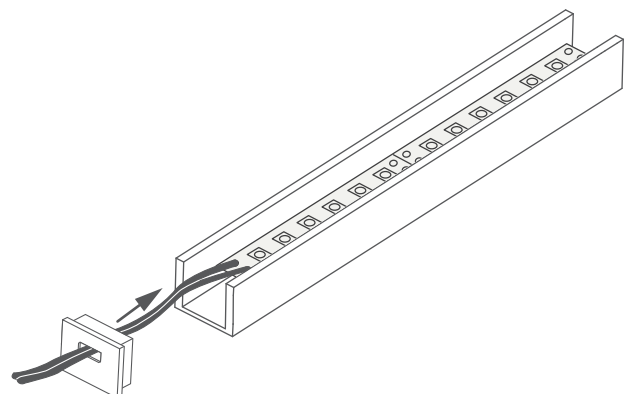

**1.** Clean dust and dirt from the extrusion and accessories.

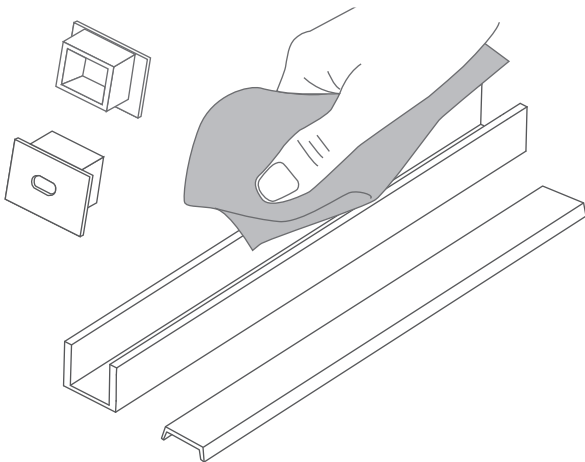

**2.** Attach the end caps with glue.

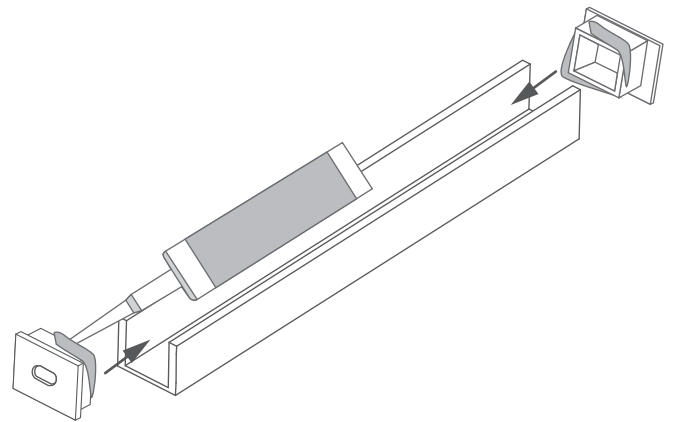

**3.** Apply a silicone layer to the bottom of the profile and embed the LED strip in it.

**NOTE:** The LED strip must have separate protection against moisture. We recommend a silicone sleeve or heat shrink tubing if the strip in the sleeve does not fit into the extrusion.

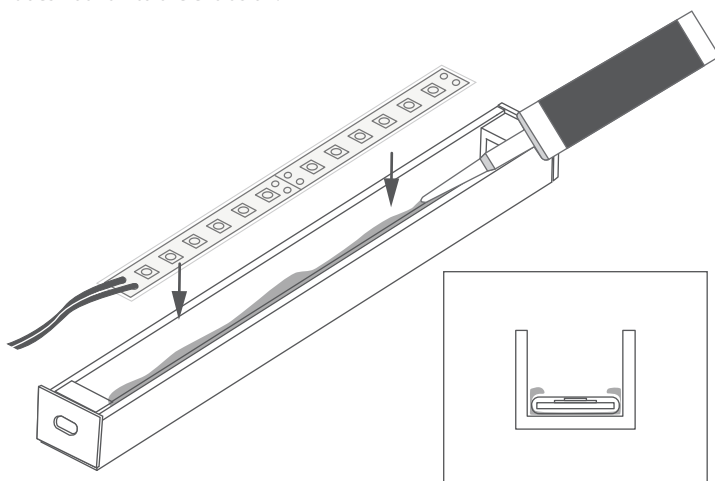

**4.** Apply a second layer of silicone on the extrusion walls and the end caps.

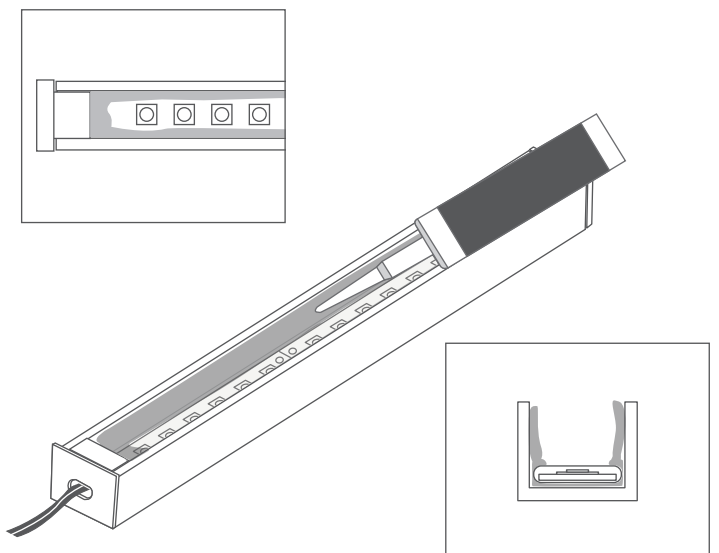

**5.** Remove the excess silicone with a rectangular tool (e.g. a piece of cardboard), taking care not to damage the tape. The silicone layer must be even and must not obscure the LEDs.

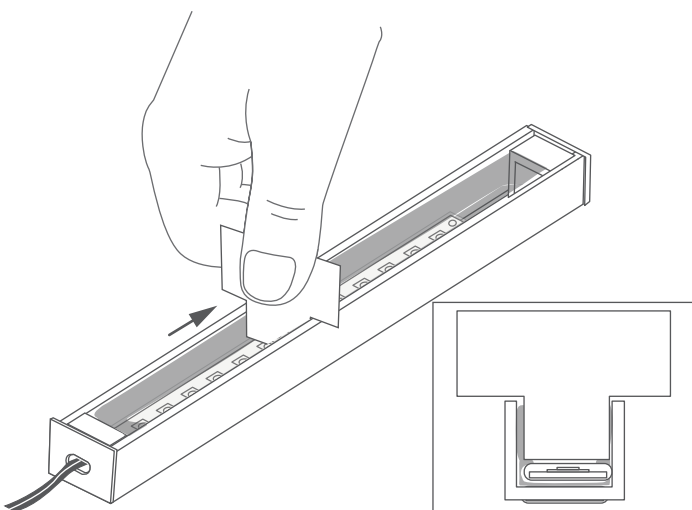

**6.** Insert the cover.

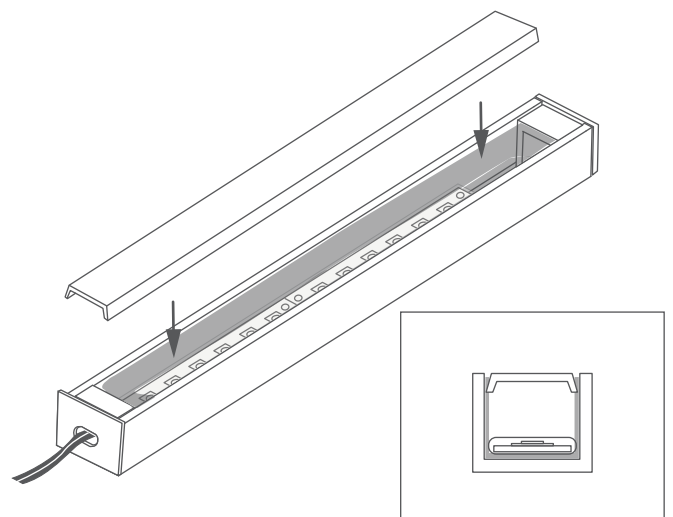

**1.** Slide the connectors into the small locks of the extrusion.

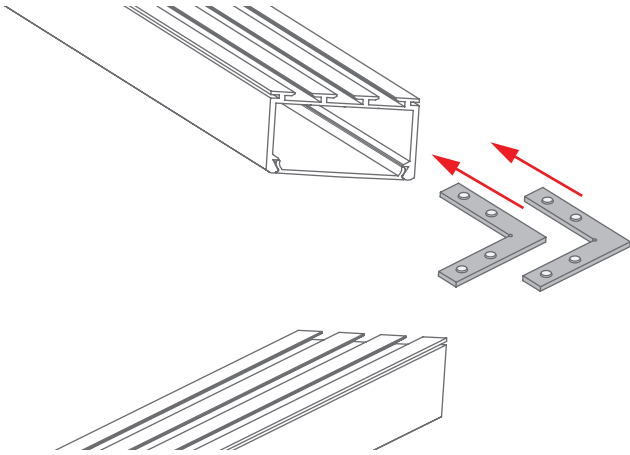

**2.** Tighten the two pressure screws in each connector with an Allen wrench.

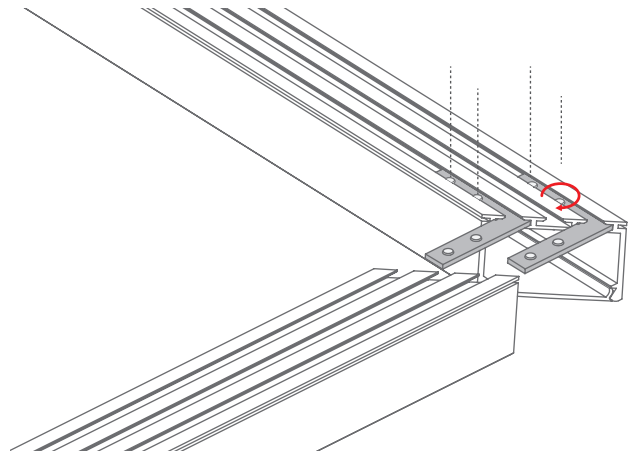

**3.** Slide the other half of the extrusion onto the connectors and tighten the pressure screws with an Allen wrench.

